

The Shoppes at Old Webster

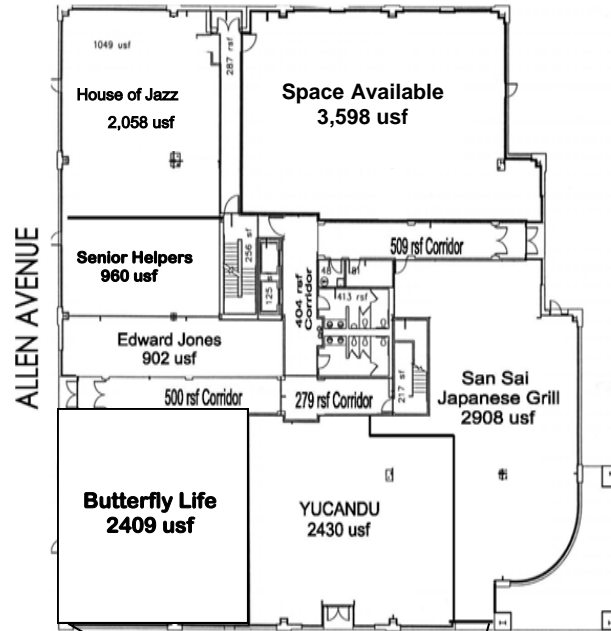

Lockwood Avenue ~ Webster Groves, MO 63119
73,959 square feet Retail/Office Development
 29,345 sq. ft. Retail / 44,614 sq. ft. Office

★ **Retail space available: 788 sq. ft. and 3,818 sq. ft.**

- Major Retail Tenants: St. Louis Bread Company, Butterfly Life, and San Sai Japanese Grill Restaurant.
- Average Household Income: \$89,114 within a 3-mile radius
- Average Household Income: \$94,167 within a 5-mile radius
- Population: 104,015 within 3-mile radius
- Population: 276,673 within a 5-mile radius
- Picturesque urban setting in pedestrian-friendly upscale business district

The information contained herein was obtained from a source we consider to be reliable. While we have no reason to doubt its accuracy, we do not guarantee it. All information contained herein is subject to change without notice.

For more information contact Novus at: 314-968-0842

